

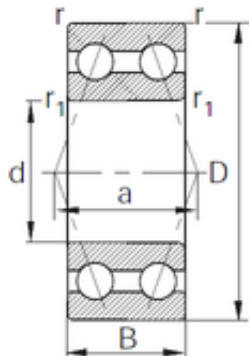

# MNT BEARING LTD

30 mm x 52 mm x 22 mm KBC SDA9102 DDY2  
Angular contact ball bearing



Bearing No. SDA9102 DDY2

Size	30x52x22 mm
Bore Diameter	30 mm
Outer Diameter	52 mm
Width	22 mm
d	30 mm
D	52 mm
B	22 mm
C	22 mm
a	28 mm
r min.	1 mm
r1 min.	0.6 mm
Basic dynamic load rating (C)	17,9 kN

SDA9102 DDY2 Bearing 2D drawings and 3D CAD models