

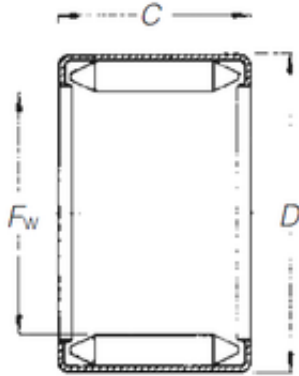

MNT BEARING LTD

Timken DL 10 12 Needle bearing



Bearing No. DL 10 12

Size	10x16x12 mm
Bore Diameter	10 mm
Outer Diameter	16 mm
Width	12 mm
Fw	10 mm
D	16 mm
C	12 mm
Weight	0,008 Kg
Basic dynamic load rating (C)	7 kN
Basic static load rating (C0)	10,9 kN
(Grease) Lubrication Speed	20000 r/min

DL 10 12 Bearing 2D drawings and 3D CAD models